

Grinding installation

Click in here

01. Adress:

Company name:

Street:

ZIP / City:

Project name:

Contactperson:

e-Mail:

Telefon no.:

Website:

02. Production range:

02.1 Vessel / Shells

	in	out	long.	circ.
- Weld seams	<input type="checkbox"/>	<input type="checkbox"/>	<input type="checkbox"/>	<input type="checkbox"/>
- Surface	<input type="checkbox"/>	<input type="checkbox"/>		
- Back gouging	<input type="checkbox"/>	<input type="checkbox"/>	<input type="checkbox"/>	<input type="checkbox"/>
- Edge preparation	<input type="checkbox"/>	<input type="checkbox"/>		

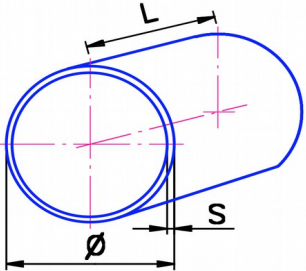

	min.		max.
Length (L)	<input type="text"/>	mm	<input type="text"/>
ø	<input type="text"/>	mm	<input type="text"/>
Thickn. (S)	<input type="text"/>	mm	<input type="text"/>

02.1.1 Rotating systems

existing (Speed from 1 - 25 m/min for surface grinding, 1 - 5 m/min for back gouging)

quote

max. weight vessel / shells kg

02.2 Dished end

	in	out
- Surface	<input type="checkbox"/>	<input type="checkbox"/>
- Edge preparation	<input type="checkbox"/>	<input type="checkbox"/>

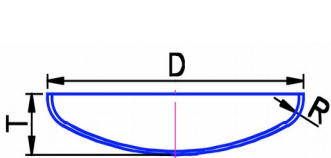

	min.		max.
ø (D)	<input type="text"/>	mm	<input type="text"/>
Depth (T)	<input type="text"/>	mm	<input type="text"/>
Radius (R)	<input type="text"/>	mm	<input type="text"/>
Thicknn (S)	<input type="text"/>	mm	<input type="text"/>

02.2.1 Dished end rotating system

existing (Speed from 1 - 30 u/min)

quote

max. weigth of the dished end kg

02.3 Cones

- Surface
- Edge preparation

in	<input type="checkbox"/>	out	<input type="checkbox"/>
	<input type="checkbox"/>		<input type="checkbox"/>

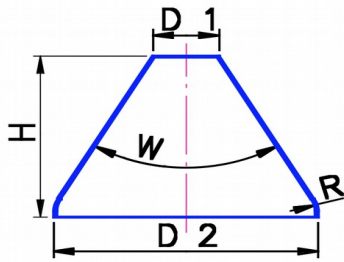

	min.		max.
∅ D1	<input type="text"/>	mm	<input type="text"/>
∅ D2	<input type="text"/>	mm	<input type="text"/>
Hght (H)	<input type="text"/>	mm	<input type="text"/>
Radius (R)	<input type="text"/>	mm	<input type="text"/>
Angle (W)	<input type="text"/>	°	<input type="text"/>
Thickn. (S)	<input type="text"/>	mm	<input type="text"/>

02.3.1 Cones rotating system

- existing
- quote

(Speed from 1 - 30 u/min)

max. weigh of the dished end kg

02.4 Special application

Description:

Drawing in e-mail attached

03. Material specification

04. General Informations

- new project
- replace existing machine

- time Schedule for possible purchase (Date)

- number of vessel, dished end, etc. per week

05. Any others
